

USER MANUAL

TRIPLE VENDING MACHINE



Lost key?
Please check this QR code to guide
you to a video that will show you
“How to remove a Lock”



If you are interested in convert -
ing your machine to a Free Spin,
please refer to this QR code to
watch a short video.

**Clean working equipment is the face
of your business.
Keep it well-groomed and Refilled.
Remember, we do it for the smiles!**



Made in China
2160 Premier Row Orlando
Florida 32809
phone: (954) 769-0510
skype: entervending.com
email: info@entervending.com

Contents

1. Product description
2. Stand assembly and machine attachment
3. Initial setup
4. Gumball dispensing wheel
5. Candy dispensing wheel
6. Coin mechanism
7. Collecting coins
8. Servicing and cleaning
9. Safety
10. Warranty

10. Warranty

All plastic and metal parts have a 1-year warranty. All moving parts of the coin mechanisms have a 3-month warranty.

The warranty does NOT cover:

1. Natural wear and tear
2. Transportation damage
3. Natural disasters or weather damage
4. Loss of income
5. Loss of products inside the globes
6. Being used in inappropriate ways
7. Using other manufacturer parts in the unit, including locks and keys



8. Servicing and cleaning

Make sure that the triple vending machine is in the great working condition by regularly servicing and cleaning the unit.

Remove crumbs and dust off the globe to keep an attractive appearance.

We also recommend washing globes with a soap once a month.

Disassemble coin mechanisms to clean and oil moving parts with a grease every 3 month to prolong the life and decrease the wear.

9. Safety

Make sure that the triple vending machine is placed in a secure area to avoid any tipping or falling over.

While servicing the machine, make sure all parts are assembled correctly & tightened to ensure proper work.

If you plan on putting the vending machine on a carpet, we advise you to use a stand with a wider base to avoid tipping or falling over.

If you notice the globe has any cracks, replace it immediately.

If you notice rust on the inner metal parts inside the globe, replace them immediately to avoid spoiling food.

Replace any broken or dirty parts within the unit as they could potentially hard your consumer health.

1. Product Description

The Triple Vending Machine has many great features, such as all-metal coin mechanisms, shatterproof polycarbonate high-quality plastic removable canisters and a unified coin box behind single-panel back door with a lock.

This vending machine is pre-configured with 1 candy dispensing wheel and 2 gumball dispensing wheels.

Both candy and gumball wheels can be precisely adjusted. Gumball wheel can be adjusted between 1 and 1.25 inches and candy wheel between 0.6 and 1.15 inches.

You can vend gumballs, bouncy balls, capsules, and self-vending toys through gumball wheel with maximum capacity up to 350 pcs. Through the candy wheel you can vend hard or jelly candy, animal feed, and nuts with maximum capacity up to 10 lb.

Machine dimensions:

Height: 19 inches / 48 cm

Width w/o spill tray: 6 inches / 15 cm

Width w/ spill tray: 10.2 inches / 26 cm

Length: 18.5 inches / 47 cm

Weight: 23 lb / 10.4 kg

Stand dimensions:

Height: 24 inches / 61 cm

Base width: 16 inches / 41 cm

Weight: 15.3 lb / 6.9 kg

Total height: 43 inches / 109 cm

2. Stand assembly and machine attachment

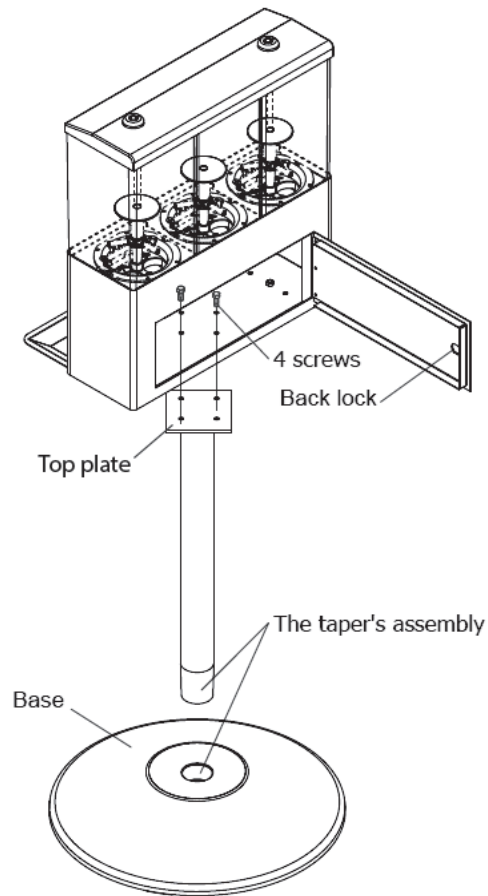

Attaching the Pole to the Base

Place the round base on the floor. Take the supporting tube and slip it into the round base.

Attaching the Machine to the Stand

Open the back door and place the machine on the top plate. Line up 4 bottom center holes of the vending machine with 4 pre-tapped holes in the top plate and place four hex bolts in those holes. Screw the hex bolts in until they are tight – **but do not overtighten** them.

7. Collecting coins

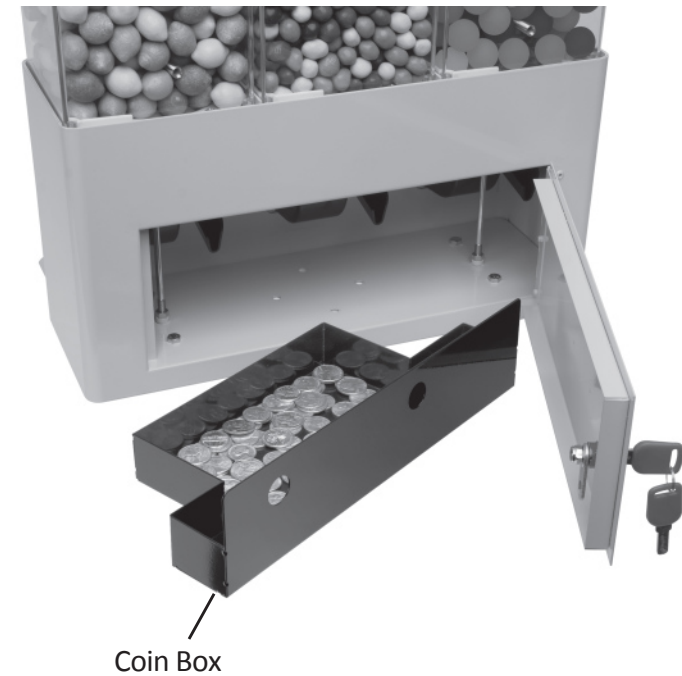

Retrieving coins

1. Unlock the back door
2. Pull the coin box
3. Retrieve coins
4. Put the coin box back
5. Lock the back door

Note: Do not overtighten the lock as only a snug fit is necessary.

6. Coin mechanism

The coin mechanisms accept one US/Canadian quarter (1 x .25 USD/CAD). Once a year depending on usage or as often as needed you should tighten up the screws on the back of the coin mechanism. Make sure do not overtighten these screws. Making them snug is all that is needed.

Removing a jammed coin

1. Remove the center screw
2. Remove the gear wheel
3. Remove three mounting screws
4. Pull the back plate away from the face plate
5. Remove a jammed coin
6. Reassemble by following the steps back

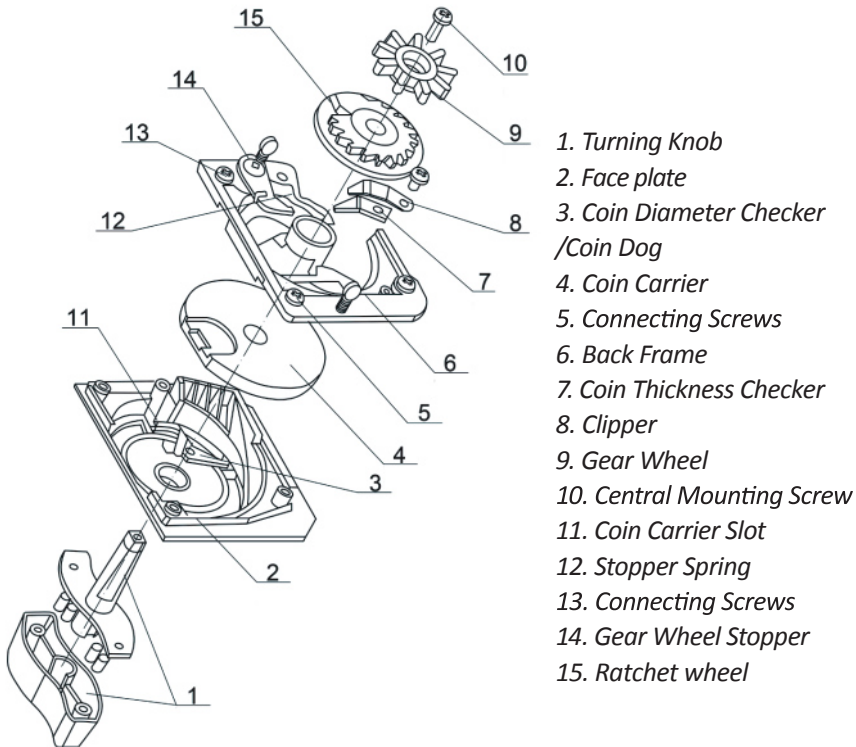

3. Initial setup

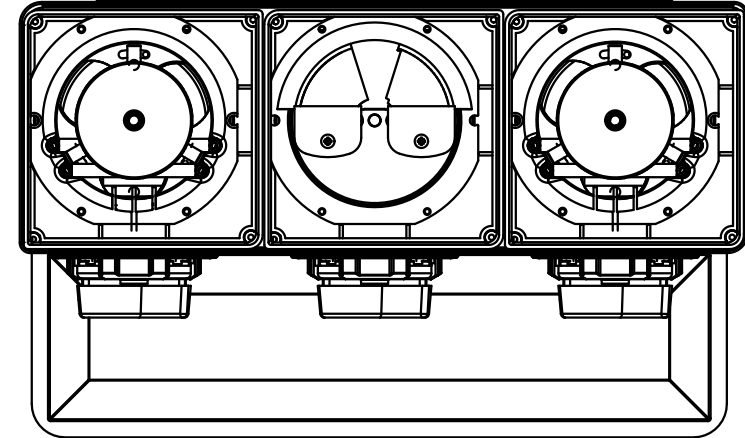

Top view of the dispensing wheels. Candy wheel is in the middle

Triple vending machine is pre-configured with 1 candy dispensing wheel in the middle and 2 gumball dispensing wheels to the sides. However, canisters are interchangeable – that means you can set them in any order you like.

You are also not restricted to this exact configuration of the dispensing wheels. Gumball and candy wheels are being sold separately, that means you can change to these configurations: only candy wheels, only gumball wheels or 2 candy wheels + 1 gumball wheel.

4. Gumball dispensing wheel

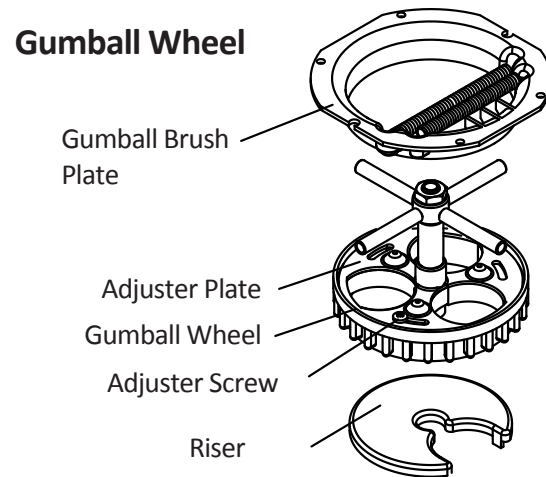

Triple Vending Machine is equipped with two multi-purpose dispensing wheels. They can be adjusted to vend products between 1 and 1.25 inches (25 mm – 32 mm), such as gumballs, bouncy balls, capsules and self-vending toys.

Adjusting the Gumball Wheel

1. Unlock and remove lid
2. Remove four screws holding the globe to the hopper
3. Remove the gumball brush plate
4. Unscrew the adjustment screws and gently adjust the wheel to a desired size. Keep in mind that a product should be loose inside the product dispensing area, so leave about 1 mm of space around the product, otherwise the product wouldn't vend. Put back and tighten the adjustment screws - do not overtighten these screws!
5. In order to vend products larger than 1 inch, remove the riser and adjust the wheel to the maximum.
6. Reassemble by following the steps back

Important! After you put the gumball brush plate back, you must line up the product dispensing area on the wheel over the product drop area.

Important! The springs on the gumball brush plate must be facing towards the coin mechanism.

5. Candy dispensing wheel

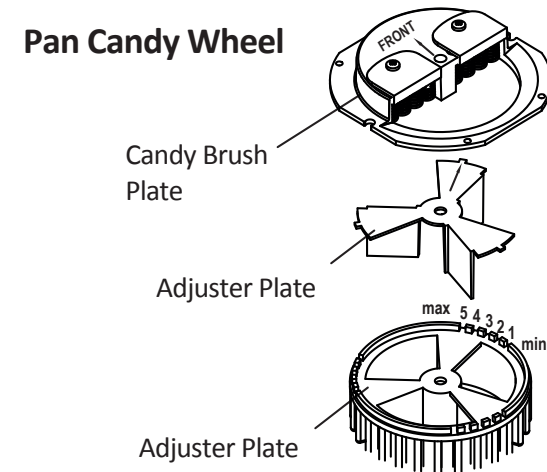

Triple Vending Machine is equipped with a bulk dispensing wheel. It can be adjusted to vend small products between 0.6 and 1.15 inches (15 mm – 30 mm) in portions, such as hard or jelly candy, nuts, animal feed and etc.

Adjusting the Candy Wheel

1. Unlock and remove lid
2. Remove four screws holding the globe to the hopper
3. Remove the candy brush plate
4. Lift up the adjuster plate and move to a desired setting notch. Notch #1 on the far left is for a small portion and notch #5 is for a large portion. The adjuster plate can be completely removed for the largest products
5. Reassemble by following the steps back

Important! Make sure that the candy brush plate is facing towards the coin mechanism when reassembling.