

Thank you for being a loyal customer!

You are now a proud owner of a reliable vending product from a reliable company! We are proud to provide great customer service and loyal support to all of our customers. Our goal is to make sure you have a smooth operation. Do you have questions about the product? Do you have something to suggest that we can improve on? Entervending's team operates to solve any problems or concerns 7 days a week.

Entervending LLC
2160 Premier Row Orlando, Florida 32809
Tel: 954 769-0510 Fax: 954 616-5658
www.entervending.com

ENTERVENDING CAPSULE MACHINE

MANUAL

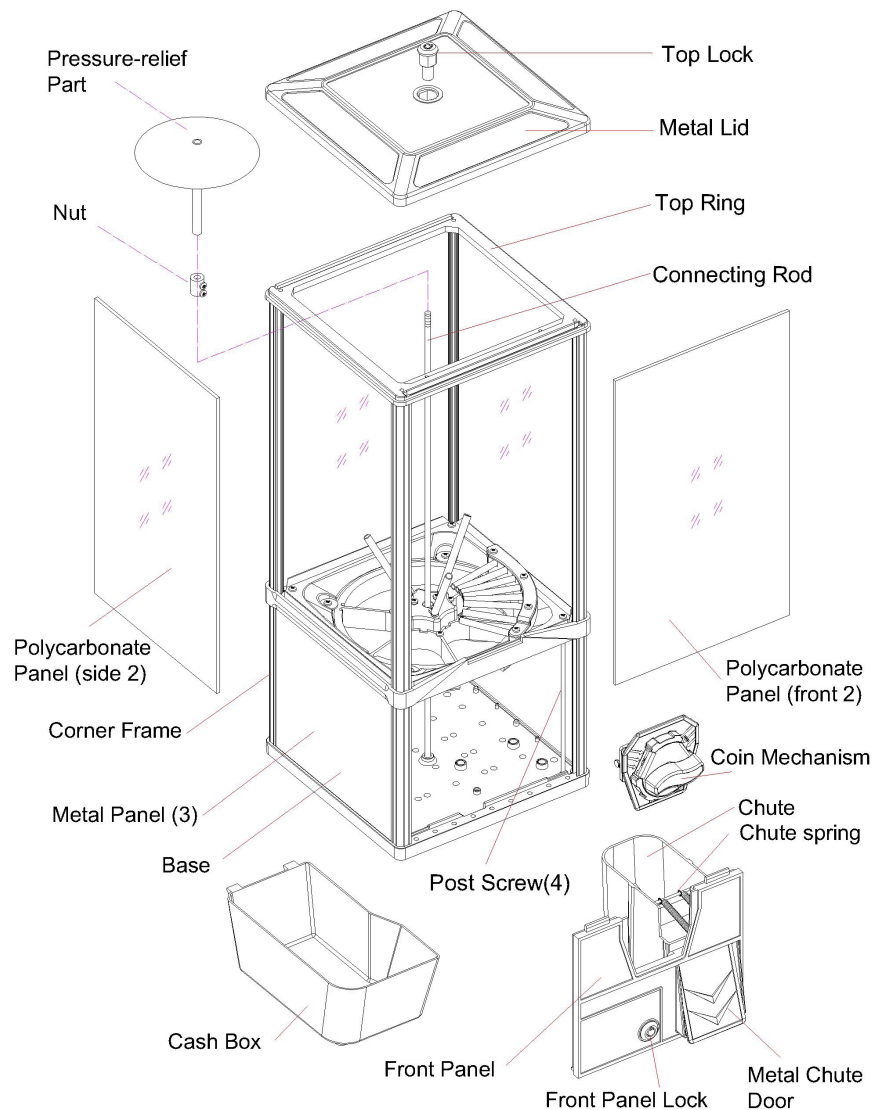

Figure 1

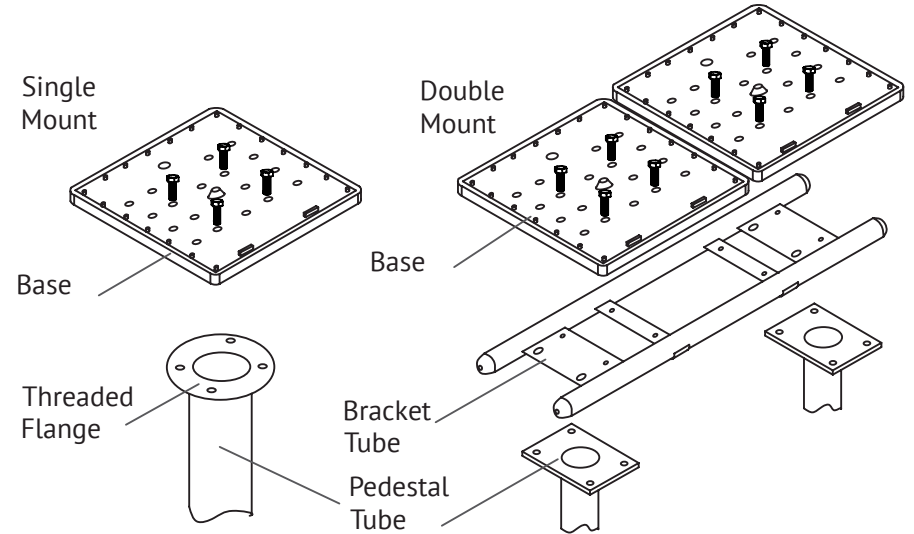

Figure 5.
Heavy Duty Cast Iron Stand Mounting

e. Align the Front and rear holes in Base as best as possible to the outer holes in the Large Double Bracket.
(Fig. 5). **NOTE: THE FRONT OF BASE HAS A NOTCH FOR THE PRODUCT CHUTE.**

Heavy-Duty Cast-Iron Stand Mounting:

f. Insert 2 bolts (Per vendor) through the large Double Bracket.

g. Apply washers and nuts. Tighten. **DO NOT OVER TIGHTEN-OVER TIGHTENING CAN CRACK THE BASE AND VOID WARRANTY**

h. Reassemble vendors.

Heavy-Duty Cast-Iron Stand

The Heavy-Duty Iron Stand itself consists of 3 main parts. The Base, The threaded Pipe and threaded Flange.

1. Single Mount:

- a. Place the threaded pipe onto the threaded opening on the Pedestal Base and tighten.
- b. Place the Threaded Flange onto the threaded pipe. Flat side up.
- c. Secure the Pedestal Base and tighten the Threaded Flange by turning Clockwise.
- d. Disassemble the vendor only to its Base (Refer to: Coin Retrieval).
- e. Align the holes within the vendor's Base to the large holes within the Threaded Flange (Fig. 5).

NOTE: THE FRONT OF BASE HAS A NOTCH FOR THE PRODUCT CHUTE.

- f. Insert 2 bolts through the threaded Flange to connect with Base.
- g. Apply washers and nuts. Tighten.
DO NOT OVER TIGHTEN.
- h. Reassemble vendor.

2. Remove Instruction & Diagram for Double Mount:

- a. Complete steps A-D as shown in Single Mount.
- b. Place the Large Double Bracket to the top. Make sure to align the large holes on the threaded Flange with the Double Bracket. (Fig. 5).
- c. insert bolts as shown. (Fig. 5).
- d. Disassemble both vendors only to its Base (See: Coin Retrieval).

Initial set-up

1. Converting the wheel dispensers:

- a. Unlock / Open lid by removing lock in an unscrewing motion.
- b. Remove the polycarbonate Panel (Front 2) and Pressure-relief Part by removing post screw (4) from the machine (Fig. 1)
- c. Remove 6 x Adjuster Screws from the gumball-dispense wheel.
- d. You are able to convert to 4 different sizes: 30mm, 40mm, 50mm & 60mm. The gumball wheel first needs to have the Riser installed (Fig. 2). The opening of the gum-wheel needs to be facing the front of the machine in order to dispense correctly. Install the gum-wheel so that holes are positioned with the opening to the hopper. Once completed, install the adjuster block and adjust the block to accommodate to the opening size requested. Next, tighten the 6 x Adjustment screws. Upon completing, install the gumball brush spring, adjuster block & brush plate by tightening 4 x screws. Vending 30mm-40mm, adjust the adjuster block to be placed on top of the brush spring (Fig. 3).

Once your desired portion/vend size is completed, fill your machine with product. Place your lid back on & tighten your lock. **NOTE: DO NOT OVERTIGHTEN THE LOCK AS ONLY A SNUG FIT IS NECESSARY.**

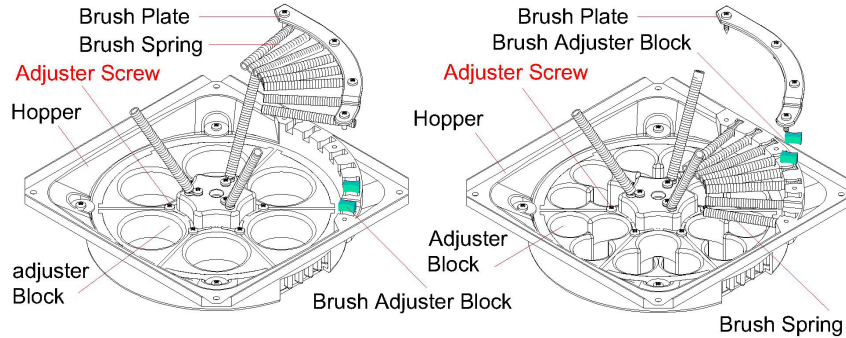

Figure 2

Figure 3

Coin Mechanism

The coin mechanism (Fig. 4) can be removed by first opening the Front Panel Lock and removing the Front Panel. (Once lock is loosened, panel is loose; Remove by lifting up and sliding down at a motion).

1. To dismantle coin mechanism:

- Remove center screw.
- Remove sprocket.
- Remove three mounting screws.
- Pull back plate away from face plate.
- Remove jammed coin.
- Replace parts in step A-F in reverse order.

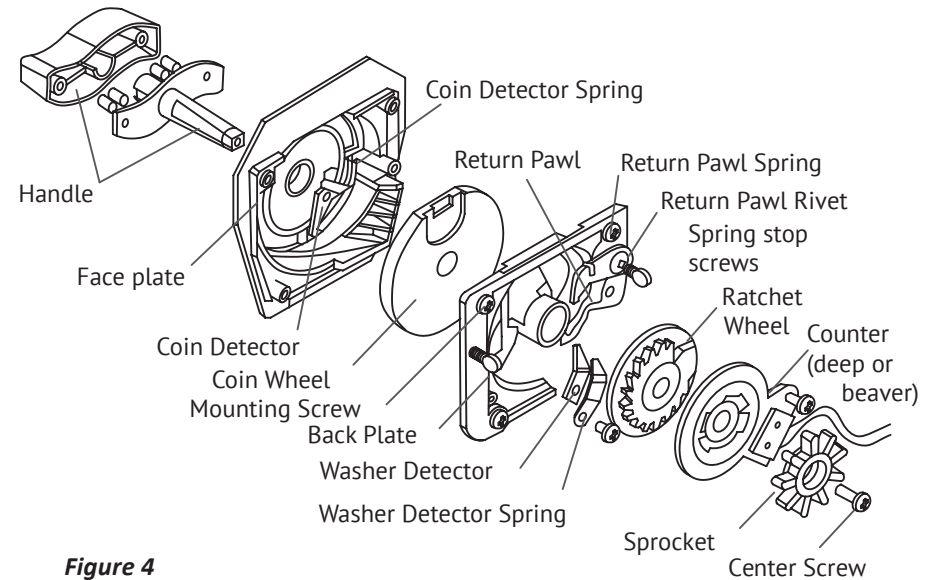

Figure 4

Coin mechanism Exploded illustration view is only for adjusting and maintenance. Extra Coin mechanism parts are sold separately

2. Retrieving coins:

- Remove lock by unscrewing to release front panel door.
- Removing the door will give you access to the coin tray.
- Grab the coin tray from the machine and empty it.
- Repeat points A-C in a reverse order to lock the machine.

NOTE: DO NOT OVERTIGHTEN THE LOCK AS ONLY A SNUG FIT IS NECESSARY.